

**BARTEC**



*Mobile Computing*

**Mobile Computer MC 9060<sup>ex</sup>-G**



## Mobile Computer MC 9060<sup>ex</sup>-G

### Features

- real time data access
- maximum usage between charges with rechargeable lithium-ion battery
- WLAN radio technology IEEE 802.11b
- Bluetooth Class II

### Description

The MC 9060<sup>ex</sup>-G mobile computer version with a pistol grip is a compact unit for safe barcode scanning in hazardous areas.

The scan trigger is conveniently positioned at the pistol grip. Thus barcodes can be captured with only one hand. The integrated radio module enables real time data access to your host system.

The MC 9060<sup>ex</sup>-G combines the strength of Microsoft's Pocket PC platform with the power of the Intel® XScale™ PXA255 processor with 400 MHz.

A further highlight is the large easy-to-read 1/4 VGA color display with touchscreen technology. The MC 9060<sup>ex</sup>-G is working with the IEEE 802.11b radio standard (direct sequence).

The MC 9060<sup>ex</sup>-G identifies the follow barcodes:

Code 11	EAN-13
Code 39	Interleaved 2 of 5
Code 93	MSI
Code 128	UPCA
Codabar	UPCE
Coupon Code	UPC/EAN supplementals
Discrete 2 of 5	Trioptic 39
EAN-8	Webcode

### ➔ Technical data

**Dimensions** (height x width x depth)  
234 mm x 91 mm x 193 mm

#### Weight

Approx. 1050 g  
(includes battery, scanner and radio)

#### Keyboard

28, 43 and 53 keys

#### Display

3.8", 1/4 VGA colour display

#### Power supply

Replaceable, Li Ion battery pack  
(2200 mAh/7.4 V)

#### CPU

XScale™ PXA255 processor at 400 MHz

#### Operating system

Windows Mobile 2003

#### Memory

64/64 MB

#### Application development

SDK available through Symbol  
Developer Zone Web site

#### Barcode options

- 1D long range scan engine
- Visible red light (650 mm)
- Scan rate 35 scans/sec
- Reading distance from 10 cm to 1220 cm

#### Protection class

IP 54

#### WLAN

- IEEE 802.11b (Direct sequence)
- Max. data rate 11 Mbps
- Frequency range 2.4 to 2.5 GHz
- Output power 100 mW
- Antenna internal

#### Bluetooth

- IEEE 802.15
- Bluetooth Class II
- Max. data rate 1 Mbps
- Antenna internal

#### Accessories

- Single Slot Cradle (Docking station for communication with the PC)
- Rapid charging station UBC 2000 (Basic station 4-slot)
- Battery adapter for UBC 2000 (with discharge option)

### ➔ Explosion protection

#### Ex protection type

Ex II 2G EEx q [ib] IIC T4

#### Certificate

PTB 05 ATEX 2055

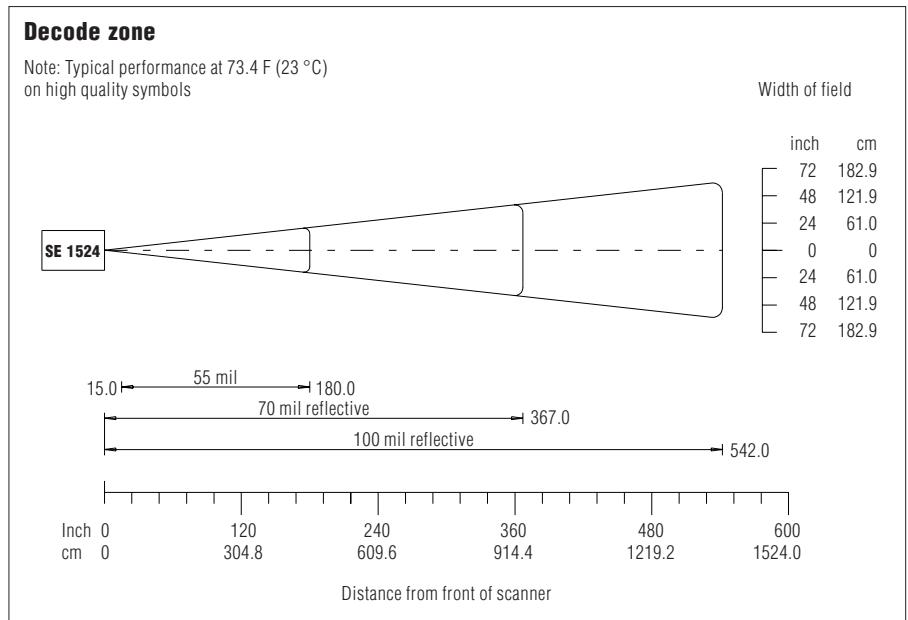
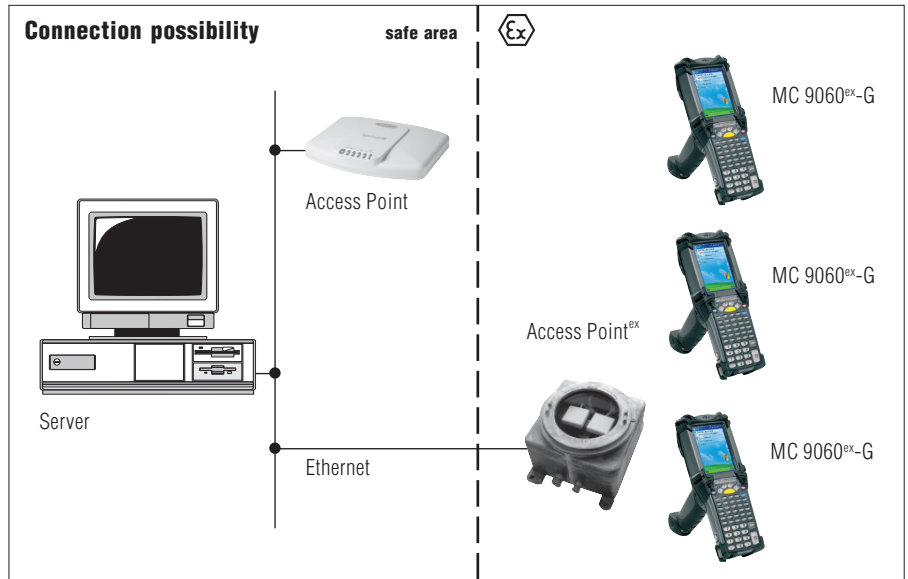

Selection chart Mobile Computer MC 9060 <sup>EX</sup> -G		
Number of keys	Key options	Code No.
28	numeric	<b>A</b>
53	alpha numeric	<b>E</b>
43	alpha numeric	<b>F</b>
53	with key code for VT Emulation	<b>G</b>
53	with key code for 3270 Emulation	<b>H</b>
53	with key code for 5250 Emulation	<b>J</b>

➔ **Complete Order No.** 17-A116-0GJ0/HB  EA700

Please insert correct code.  
Technical data subject to change.

Note: All variants without accessories. Order-No. and prices for accessories see price list.

BARTEC protects  
people and  
the environment  
by the safety

of components,  
systems  
and plants.

